



# Location:



## 6605-TRM, 6605TRMTC Shower/Hand Shower Trim Specification Submittal

Feature Highlights	Options/Modifications
<ul style="list-style-type: none"><li>Unity Shower/Hand Shower Trim</li><li>Requires Temptrol® Pressure Balancing Tub/Shower Valve</li><li>Requires Symmons Dual Outlet Diverter Valve</li><li>Metal lever handle</li><li>Cradle for hand shower wand</li><li>Dual checks for backflow protection</li><li>60" flexible metal hose</li><li>1 mode hand shower wand with easy to clean nozzles</li><li>1 mode showerhead with easy to clean nozzles</li><li>2.0 gpm (7.6 L/min) flow restrictors</li><li>Components shall be metal and nonmetallic construction, plated in standard Polished Chrome finish</li><li>Available with TA-10 flow control spindle and T-12A cap assembly for Temptrol valve bodies installed with Test Cap (order p/n 6605TRMTC)</li><li>For optional in-line vacuum breaker order p/n EF-109</li></ul>	<ul style="list-style-type: none"><li><input type="checkbox"/> <b>1.5</b> <b>CG</b> 1.5 gpm (5.7 L/min) flow restrictor</li><li><input type="checkbox"/> <b>L1</b> Less showerhead</li><li><input type="checkbox"/> <b>L2</b> Less hand shower (wand only)</li><li><input type="checkbox"/> <b>L3</b> Less showerhead &amp; hand shower wand</li><li><input type="checkbox"/> <b>L4</b> Less head, arm and flange</li><li><input type="checkbox"/> <b>L5</b> Less hand shower system (less cradle, hose, wand &amp; elbow)</li><li><input type="checkbox"/> <b>L7</b> Less handle</li><li><input type="checkbox"/> <b>STN</b> Satin Nickel finish</li></ul> <p><b>Note:</b> Append appropriate -suffix to model number.</p>
Model Numbers	Warranty
<ul style="list-style-type: none"><li><input type="checkbox"/> <b>6605-TRM</b> Shower/Hand Shower Trim, Temptrol Pressure Balancing Tub/Shower Valve and Symmons Dual Outlet Diverter valve ordered separately</li><li><input type="checkbox"/> <b>6605TRMTC</b> Shower/Hand Shower Trim with TA-10 flow control spindle and T-12A cap assembly, must order Temptrol valve with Test Cap</li></ul>	<p><b>Limited Lifetime</b> - to the original end purchaser in consumer/residential installations.</p> <p><b>10 Years</b> - for commercial/industrial installations. Refer to <a href="http://www.symmons.com/warranty">www.symmons.com/warranty</a> for complete warranty information.</p> 
Compliance	
<ul style="list-style-type: none"><li>ASME A112.18.1/CSA B125.1</li><li>WaterSense 1.5 gpm (5.7 L/min)</li><li>2.0 gpm (7.6 L/min)</li></ul>  	

## Architectural/ Engineering Specification

Symmons \_\_\_\_\_ With Unity Shower/Hand Shower Trim, requires Temptrol® pressure balancing tub/shower valve, Requires Symmons Dual Outlet Diverter Valve, metal lever handle, Cradle for hand shower wand, Dual checks for backflow protection, 60" flexible metal hose, 1 mode hand shower wand with easy to clean nozzles, 1 mode showerhead with easy to clean nozzles, 2.0 gpm (7.6 L/min) flow restrictor, Tub spout and showerhead not included, components shall be metal and nonmetallic construction, plated in standard Polished Chrome finish, available with TA-10 flow control spindle and T-12A cap assembly for Temptrol valve bodies installed with Test Cap (order p/n 6605TRMTC), For optional in-line vacuum breaker order p/n EF-109. 10 Year commercial Warranty. ASME A112.18.1/CSA B125.1, WaterSense 1.5 gpm (5.7 L/min), 2.0 gpm (7.6 L/min) Complaint. Available options include "1.5 - 1.5 gpm (5.7 L/min) flow restrictor", "L1 - Less showerhead", "L2 - Less hand shower wand", "L3 - Less showerhead & hand shower wand", "L4 - Less head, arm and flange", "L5 - Less hand shower system", "L6 - Less tub spout", "L7 - Less handle", "STN - Satin nickel finish".

6605-TRM, 6605TRMTC

## Dimensions

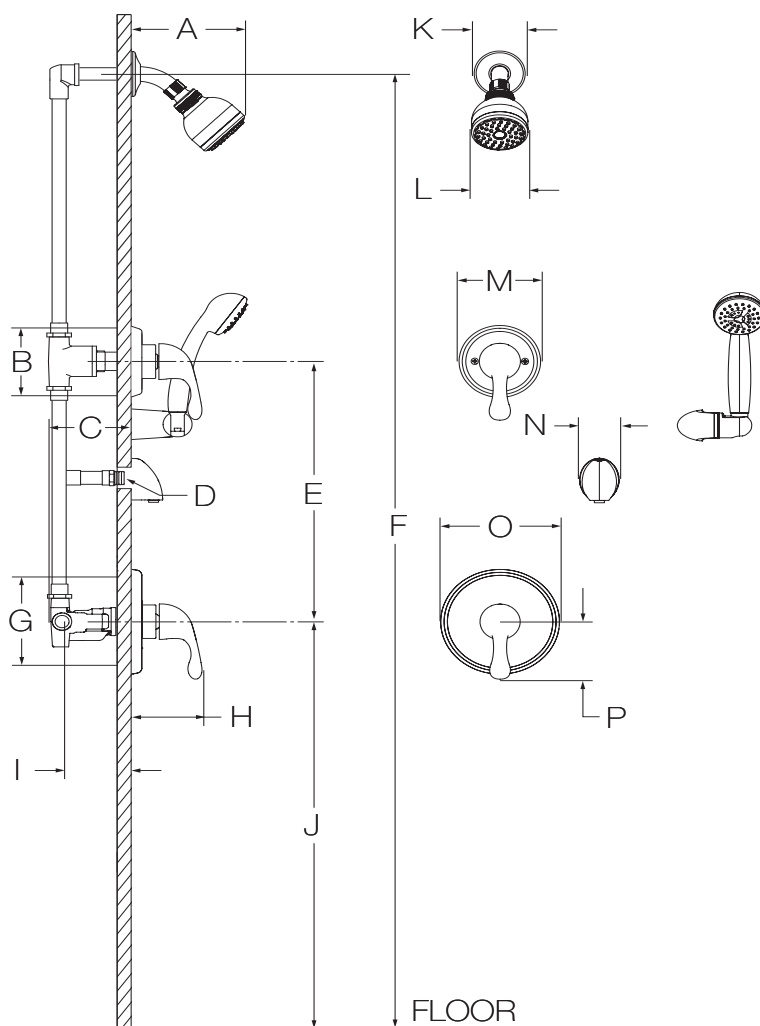

Measurements	
<b>A</b>	6-3/8", 162 mm
<b>B</b>	Diverter Valve Hole Size Min. Ø 3", 76 mm Max. Ø 3-1/4", 83 mm
<b>C</b>	3-1/2", 89 mm
<b>D</b>	Male 1/2" NPT fitting must be recessed 1/4" (6 mm) from finished wall
<b>E</b>	Ref. 10", 254 mm
<b>F</b>	Ref. 77", 1956 mm
<b>G</b>	Shower Valve Hole Size Min. Ø 3", 76 mm Max. Ø 4", 102 mm
<b>H</b>	3-3/4", 95 mm
<b>I</b>	Rough-in 2-3/8" ± 1/2", 60 mm ± 13 mm
<b>J</b>	Ref. 42", 1067 mm
<b>K</b>	Ø 2-1/2", 64 mm
<b>L</b>	Ø 2-3/4", 70 mm
<b>M</b>	Ø 4-1/4", 108 mm
<b>N</b>	2-1/8", 54 mm
<b>O</b>	Ø 6-3/8", 162 mm
<b>P</b>	3-1/2", 89 mm

### Notes:

- 1) Valve body and piping not included and shown as reference only.
- 2) Plaster shield (p/n T-176) for dry wall, plaster or other type walls 1/2" or greater.
- 3) All dimensions measured from nominal rough-in (see I as reference).
- 4) Dimensions subject to change without notice.