

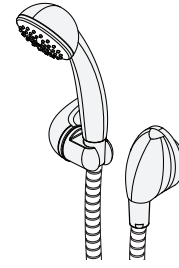

**SYMMONS®**



H301-V

H301-V

Hand Shower

**Operation & Maintenance Manual**

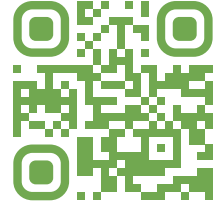
Model Numbers	Feature Highlights
<input type="checkbox"/> <b>H301-V</b> <i>Hand Shower</i>	<ul style="list-style-type: none"> <li>• 1 mode hand shower unit</li> <li>• Dual checks for backflow protection</li> <li>• 2.0 gpm (7.6 L/min) flow rate</li> <li>• Polished chrome finish (standard)</li> </ul>
Options/ Modifications	
<input type="checkbox"/> <b>1.5</b> <b>1.5 gpm (5.7 L/min) flow restrictor</b> <input type="checkbox"/> <b>STN</b> <b>Satin Nickel finish</b> <input type="checkbox"/> <b>MB</b> <b>Matte Black finish</b> <input type="checkbox"/> <b>BBZ</b> <b>Brushed bronze finish</b> <input type="checkbox"/> <b>72</b> <b>6 foot hand shower hose in place of standard 5 foot hose</b>  <b>Note:</b> Append appropriate -suffix to model number.	
Compliance	Warranty
<p>-ASME A112.18.1/CSA B125.1</p> <div style="text-align: right;">  </div> <p><b>⚠ WARNING:</b> This product can expose you to chemicals including lead, which is known to the state of California to cause cancer, birth defects, or other reproductive harm. For more information, go to <a href="http://www.P65Warnings.ca.gov">www.P65Warnings.ca.gov</a>.</p>	<p><b>Limited Lifetime</b> - to the original end purchaser in consumer/residential installations.</p> <p><b>10 Years</b> - for commercial/industrial installations. Refer to <a href="http://www.symmons.com/warranty">www.symmons.com/warranty</a> for complete warranty information.</p> <div style="text-align: right;">  </div>

## Dimensions

Hand Shower, H301-V

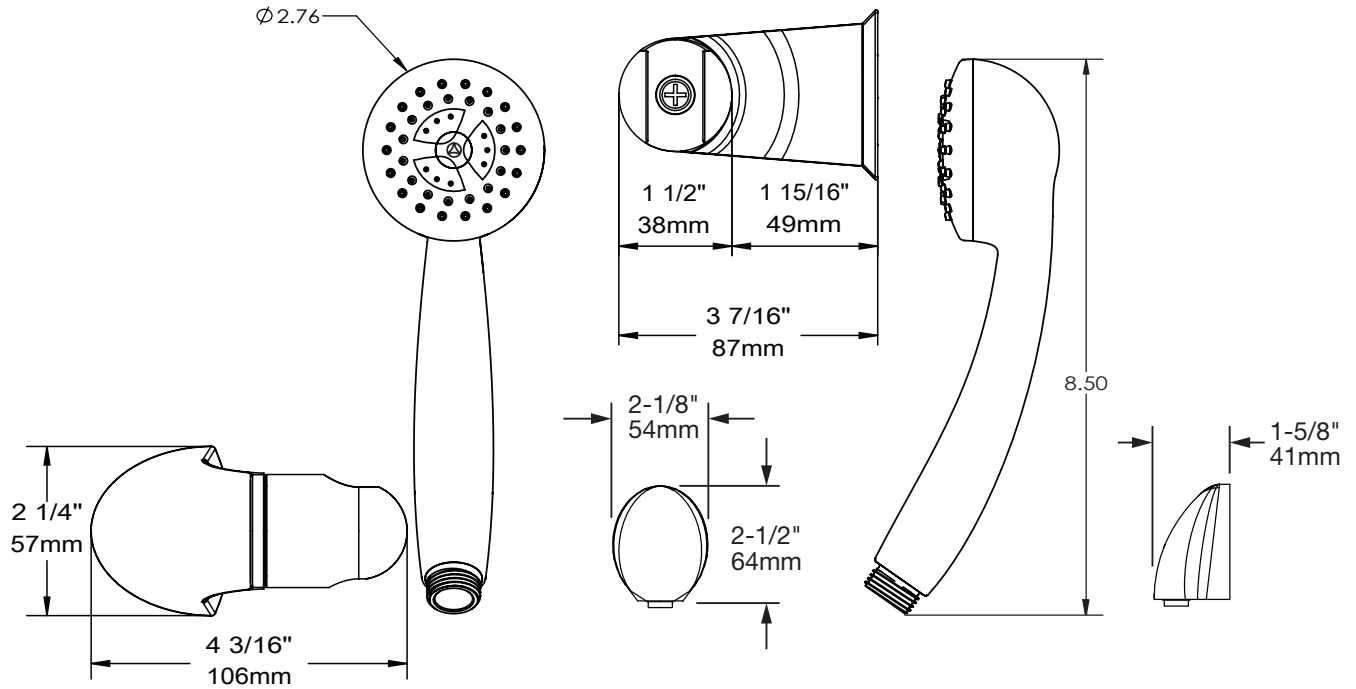

**Note:** Dimensions subject to change without notice.

## Iso-View

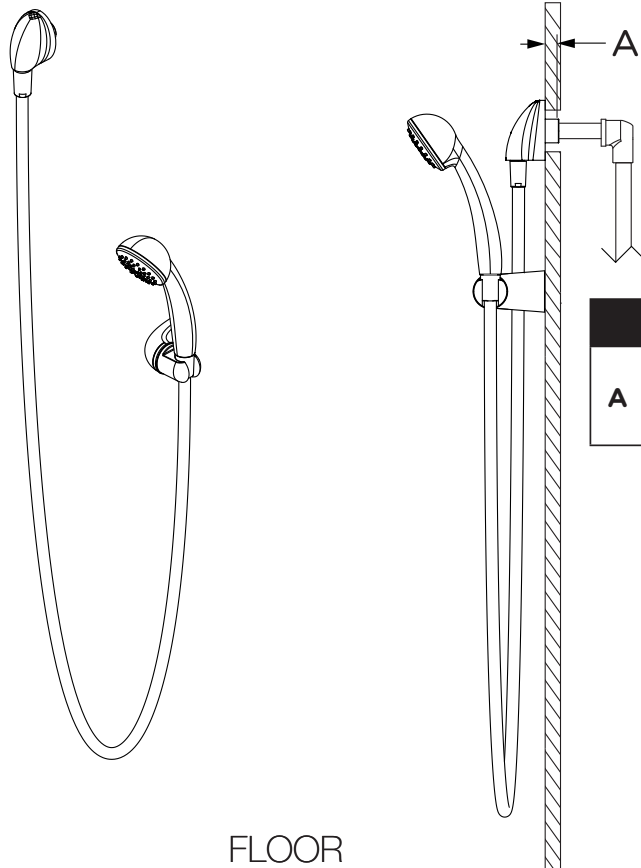

### Measurements

<b>A</b>	Male 1/2-14 NPT fitting must be recessed 1/4" (6 mm) from finished wall
----------	---

## Tools Required



Adjustable Wrench

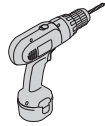

Drill

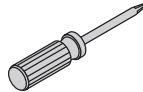

Phillips Head Screwdriver



Plumber Tape

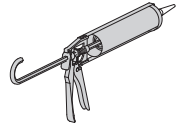

Silicone

## Parts Breakdown

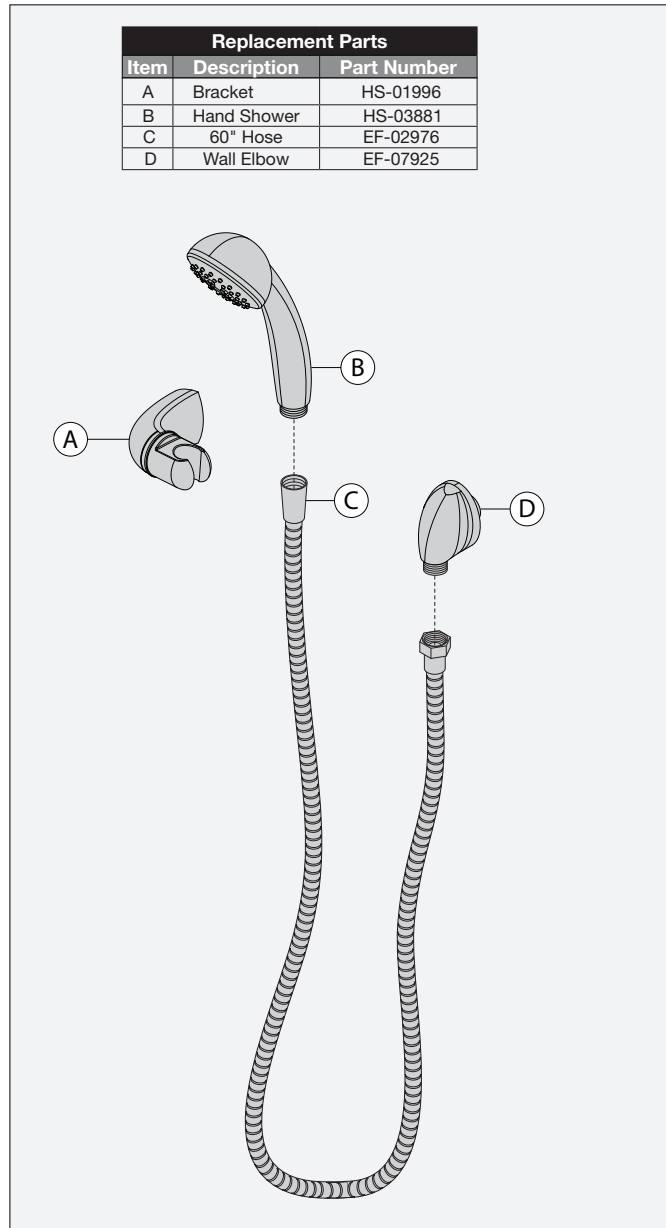

### Notes:

- 1) Apply a bead of silicone around the perimeter of all shower trim installed flush to the finished wall.
- 2) Apply plumber tape to all threaded connections.