

Location:



SLC6712CA

Two Handle Centerset Lavatory Faucet

Specification Submittal



Model Numbers

- ☐ **SLC6712CA** Two Handle Centerset Lavatory Faucet with lift rod and metal drain assembly

Options/ Modifications

- ☐ **STN** **Satin nickel finish**
- ☐ **BBZ** **Brushed Bronze finish**
- ☐ **MB** **Matte Black finish**

Note: Append appropriate suffix to model number.

Compliance

-ASME A112.18.1/CSA B125.1

-NSF/ANSI/CAN 61: Q<1, NSF/ANSI 372

-WaterSense 1.0 gpm



Feature Highlights

- Two handle centerset lavatory faucet features 4" mount
- Ceramic cartridges
- 1/2" IPS inlet connections
- 1.0 gpm (3.8 L/min) standard flow rate
- Faucet constructed from brass
- Plated in standard polished chrome finish

Warranty

Limited Lifetime - to the original end purchaser in consumer/residential installations.

10 Years - for commercial/industrial installations. Refer to www.symmons.com/warranty for complete warranty information.

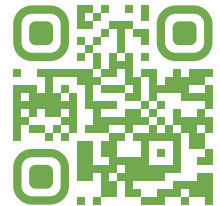

Architectural/ Engineering Specification

Symmons Identity Two Handle Centerset Lavatory Faucet _____ Includes Two handle centerset lavatory faucet features 4" mount, Ceramic cartridges, 1/2" IPS inlet connections, 1.0 gpm (3.8 L/min) standard flow rate, Faucet constructed from brass, Plated in standard polished chrome finish. 10 Year Commercial Warranty. ASME A112.18.1/CSA B125.1, NSF/ANSI/CAN 61: Q<1, NSF/ANSI 372, WaterSense 1.0 gpm compliant. Available options: "STN - Satin nickel finish", "BBZ - Brushed Bronze finish", "MB - Matte Black finish".

Dimensions

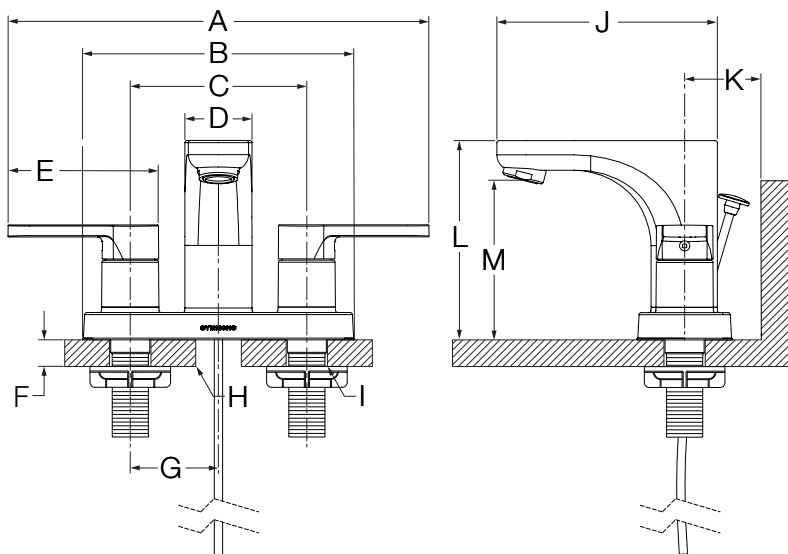

Note: Dimensions subject to change without notice.

Measurements

A	9-1/2", 241 mm
B	6-1/8", 156 mm
C	4", 102 mm
D	1-1/2", 38 mm
E	(2x) 3-3/8", 86 mm
F	Deck Thickness Ref. Min. 3/4", 19 mm Max. 1-1/2", 38 mm
G	(2x) 2", 51 mm
H	Hole Size Min. Ø 1-1/4", 32 mm Max. Ø 1-3/8", 35 mm
I	(2x) Hole Size Min. Ø 1-1/8", 29 mm Max. Ø 1-1/4", 32 mm
J	5", 127 mm
K	Min. 2-1/4", 57 mm
L	4-1/2", 114 mm
M	3-5/8", 92 mm