

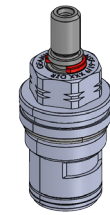

KN-113 and KN-114
Cartridge
Specification Submittal



Location:

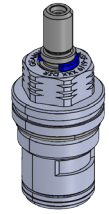

KN-114



KN-113

Model Numbers	Feature Highlights
<input type="checkbox"/> KN-113 Valve Cartridge, Cold <input type="checkbox"/> KN-114 Valve Cartridge, Hot	<ul style="list-style-type: none"> Cartridge with ceramic control components.
Compliance	Warranty
<ul style="list-style-type: none"> ASME A112.18.1/CSA B125.1. 	<p>Limited Lifetime - for residential installations. 10 Years - for commercial/industrial installations. Refer to www.symmons.com/warranty for complete warranty information.</p> 

Architectural/Engineering Specification

Symmons Cartridge _____ Feature includes cartridge with ceramic control components. 10-Year Commercial Warranty. ASME A112.18.1/CSA B125.1 compliant.

Dimensions

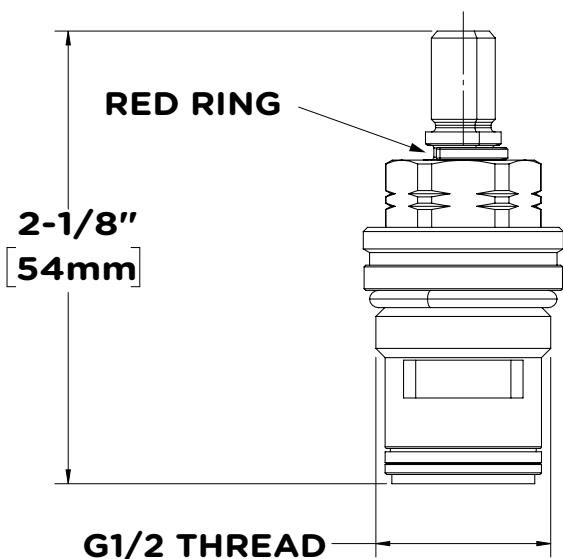

KN-114 HOT

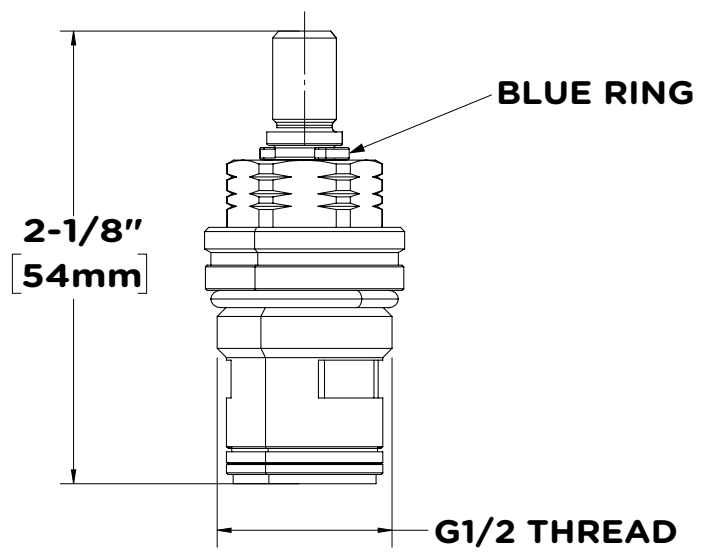

KN-113 COLD

Note: Dimensions subject to change without notice.