

Location:

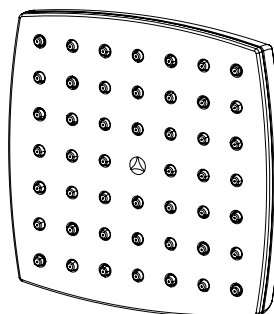

562SH
1-Mode Square Showerhead
Specification Submittal

Specification

- 1-Mode showerhead
- 5" square
- 2.0 gpm (7.6 L/min) standard flow rate restrictor

Model Numbers

- ☐ **562SH**
1-Mode square showerhead

Modifications/Options

- ☐ **15**  1.5 gpm (5.7 L/min) flow rate restrictor

Warranty

Limited Lifetime - to the original end purchaser in consumer/residential installations.

10 Years - for commercial/industrial installations. Refer to www.symmons.com/warranty for complete warranty information.



Note: Append appropriate suffix to model number.

Compliance

-ASME A112.18.1/CSA B125.1



Architectural/Engineering Specification

Symmons Oak 1-Mode Square Showerhead _____ Includes 1-Mode showerhead, 5" square, 2.0 gpm (7.6 L/min) standard flow rate restrictor. 10 Year Commercial Warranty. ASME A112.18.1/CSA B125.1 complaint. Available options: "15 - 1.5 gpm (5.7 L/min) flow restrictor".

Dimensions

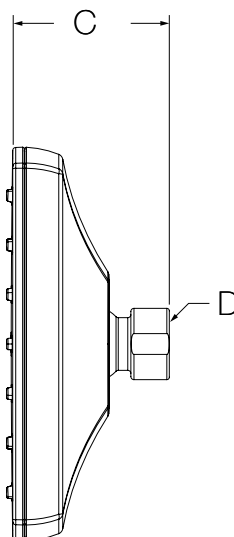
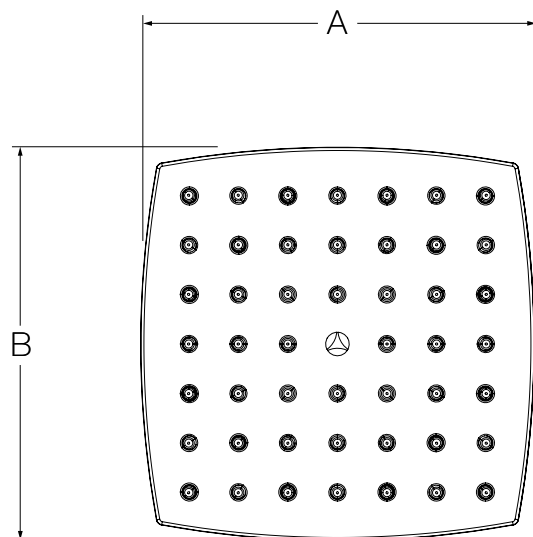

Measurements

| A | 5", 127 mm |
|----------|---------------|
| B | 5", 127 mm |
| C | 2", 51 mm |
| D | 1/2" - 14 NPT |

Note: Dimensions subject to change without notice.