



Location:



3504-B
Tub/Hand Shower System
Specification Submittal



Model Numbers	Compliance
<input type="checkbox"/> 3504-B Tub/Hand Shower System	-ASME A112.18.1/CSA B125.1 
Modifications	Warranty
<input type="checkbox"/> -1.5  1.5 gpm (5.7 L/min) flow restrictor <input type="checkbox"/> -Delete Suffix B Chrome plastic escutcheon on valve with color graphics/indicators in place of standard brass escutcheon <input type="checkbox"/> -MB Matte Black finish <input type="checkbox"/> -BBZ Brushed Bronze finish <input type="checkbox"/> -STN Satin Nickel finish <input type="checkbox"/> -L2 Less hand shower (wand only) <input type="checkbox"/> -L5 Less hand shower system (less bar/cradle, hose, wand and elbow) <input type="checkbox"/> -L6 Less tub spout <input type="checkbox"/> -L7 Less handle <input type="checkbox"/> -TRM Trim only, valve not included Note: Append appropriate -suffix to model number.	Limited Lifetime - to the original end purchaser in consumer/residential installations. 10 Years - for commercial/industrial installations. Refer to www.symmons.com/warranty for complete warranty information. 

Architectural/Engineering Specification

Symmons Dia Tub and Hand Shower System _____ Includes Temptrol® Pressure Balancing valve. Features adjustable stop screw to limit handle turn, 30" slide bar, in-line vacuum breaker, 60" flexible metal hose, diverter tub spout, 1 mode hand shower and standard 2.0 gpm (7.6 L/min) flow restrictors. Components made from metal and nonmetallic materials plated in standard polished chrome finish. 10 Year Commercial Warranty. ASME A112.18.1/CSA B125.1 compliant. Available options: "1.5 - 1.5 gpm (5.7 L/min) flow restrictor", "Delete Suffix B - Chrome plastic escutcheon on valve with color graphics/indicators in place of standard brass escutcheon", "MB - Matte Black finish", "BBZ - Brushed Bronze finish", "STN - Satin Nickel finish", "L2 - Less hand shower (wand only)", "L5 - Less hand shower system (less bar/cradle, hose, wand and elbow)", "L6 - Less tub spout", "L7 - Less handle", "TRM - Trim only, valve not included".



Dimensions

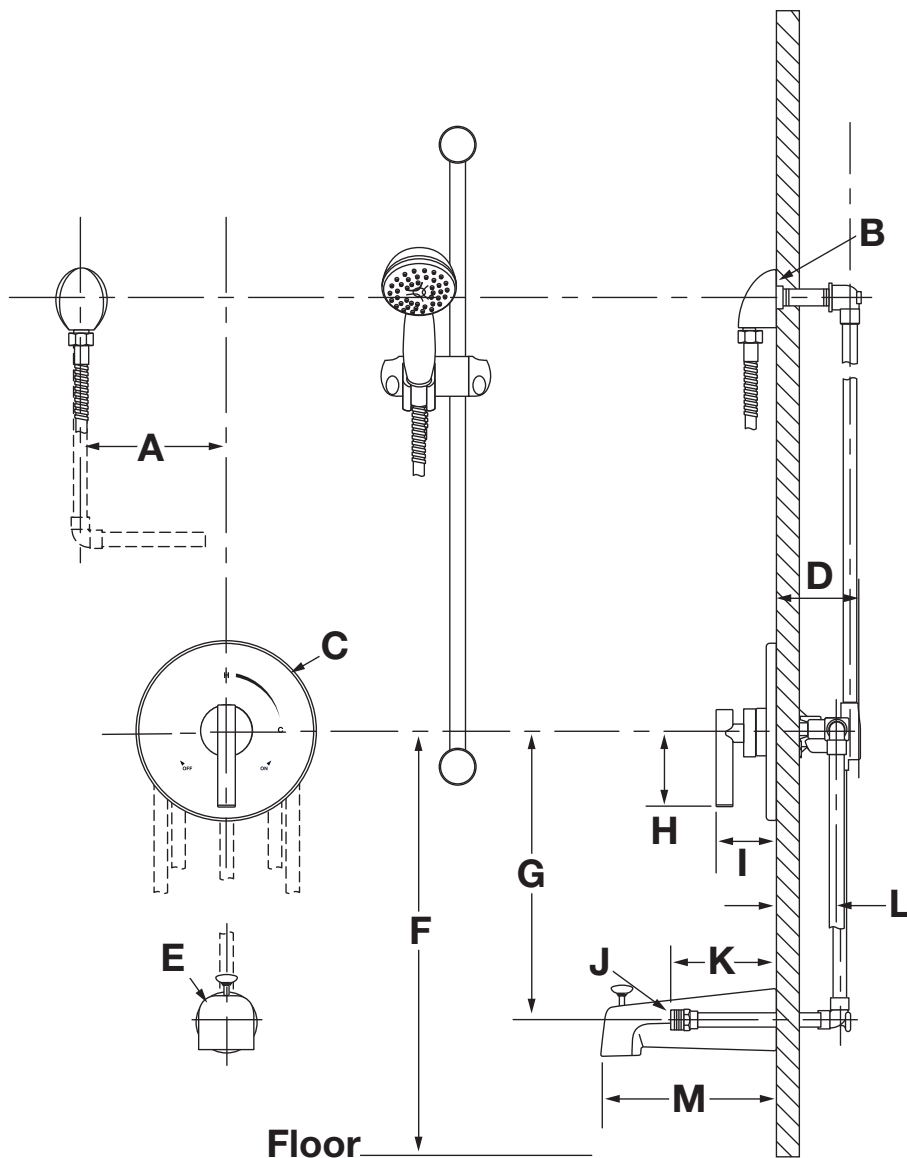

Measurements	
A	6", 152 mm
B	Male 1/2-14 NPT thread must be recessed 1/4" (6 mm) from finished wall
C	Ø 7-1/2", 191 mm
D	3-1/2", 89 mm
E	Ø 2-1/2", 64 mm
F	Ref. 32", 813 mm
G	Ref. 12", 305 mm
H	3", 76 mm
I	2-7/8", 73 mm
J	Male 1/2-14 NPT fitting must protrude 5-1/2" (140 mm) from finished wall
K	5-1/2", 140 mm
L	Rough-in 2-3/8" ± 1/2", 60 mm ± 13 mm
M	7", 178 mm

Notes:

- 1) All dimensions measured from nominal rough-in (see L as reference).
- 2) Dimensions are subject to change without notice.