

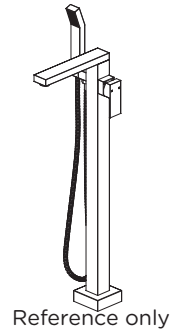

Freestanding Tub Filler Install Guide

Note:

This install guide is applicable for all Symmons free-standing tub fillers.



Warranty

Limited Lifetime - for residential installations.
10 Years - for commercial/industrial installations.
 Refer to www.symmons.com/warranty for complete warranty information.



Product Care

Clean finished trim area with a soft cloth using mild soap and water or a non-abrasive cleaner, and then quickly rinse with water.

Tools Required

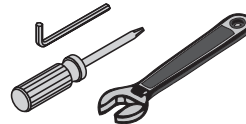

Installation A) Wooden Subfloor With Access Underneath

Section A:

1. Using the included dimensions (shown in Figure 3), measure and mark centerlines for the mounting bracket on the subfloor as shown in Figure 2 (Max. 1-1/2" thickness as shown in Figure 4).
2. Using the floor flange (1) as a template, drill one 2" hole for the piping and four 1/4" holes for the mounting bolts.
3. Align the holes of the floor flange with the holes in the floor as shown in Figure 5, and insert the four mounting bolts (2) as shown in Figure 6. Ensure that the hex heads of the bolts lock into the holding recesses in floor flange.
4. From underneath, install the holding plate (3), washers, lock washers, and nuts (4) as shown in Figure 7. Tighten all four nuts securely with a wrench, in an alternating star pattern for consistent stability.

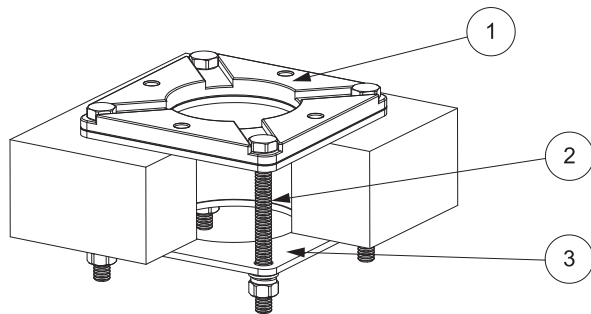

Figure 1

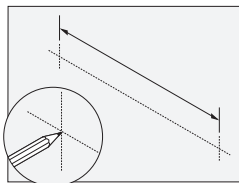

Figure 2

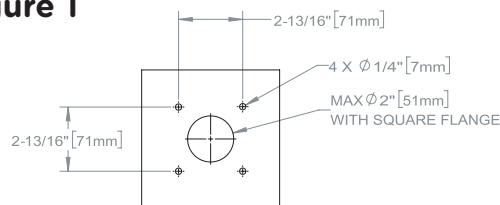

Figure 3

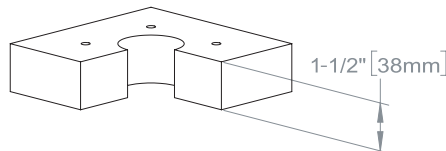

Figure 4

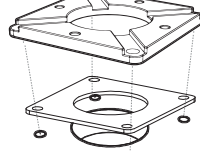

Figure 5

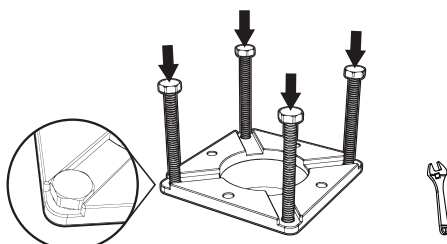

Figure 6

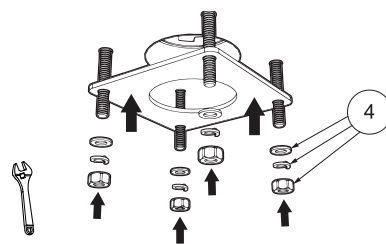

Figure 7

Section A

Installation A) (Continued)

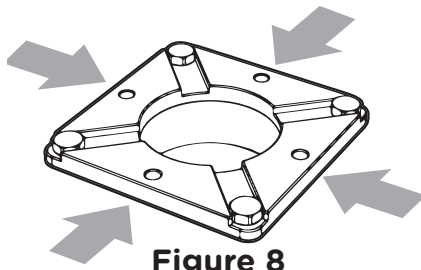

Figure 8
Section B

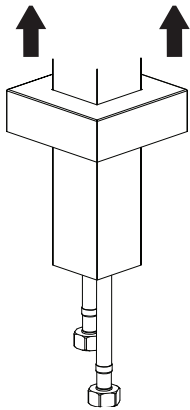

Figure 9
Section C

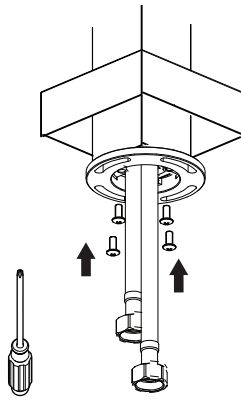

Figure 10

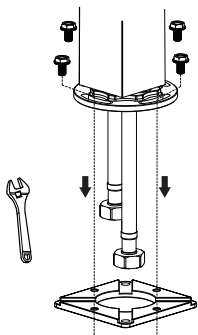

Figure 11

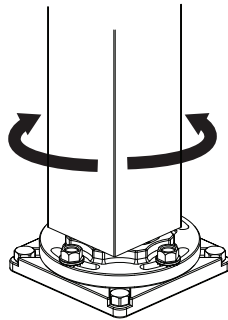

Figure 12

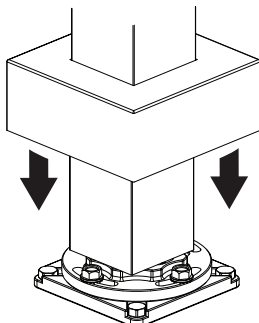

Figure 13
Section D

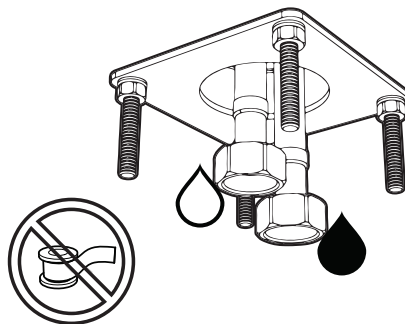

Figure 15
Section F

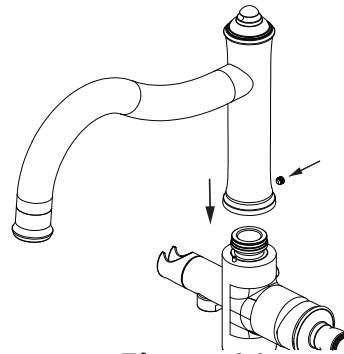

Figure 14
Section E

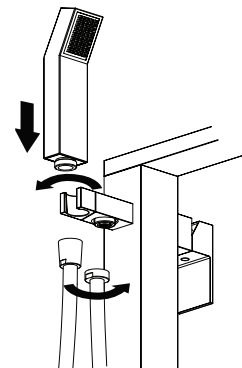

Figure 16
Section G

Section B:

5. Install flooring around the floor flange as shown in Figure 8.

Section C:

6. Slide the decorative flange onto the tub filler body as shown in Figure 9.
7. Attach the flange to the body, using the four screws provided as shown in Figure 10.

Section D:

Direct Tub Filler Body Installation:

8. Connect the tub filler body and the floor flange together using the screws provided as shown in Figure 11.
- Note: Do not tighten screws entirely.*
9. Before tightening the screws, rotate the tub filler body to the preferred position for the spout as shown in Figure 12.
10. Slide the decorative flange over the floor flange until it is flush with the floor as shown in Figure 13.

Section E If Applicable:

11. If spout is packaged separately, attach the spout to tub filler body. Align the spout with pin in the tub filler body and tighten the set screw as shown in Figure 14.

Section F:

12. Connect the cold and hot water inlets. Turn on water supply and check for leaks as shown in Figure 15.

Section G:

13. Connect the hose and hand shower wand to the shower holder connector as shown in Figure 16. Check for leaks.

Installation B) Subfloor Without Access Underneath

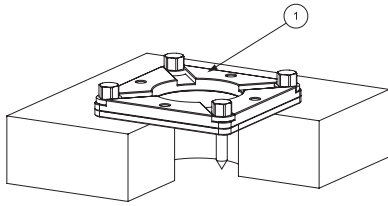

Figure 17

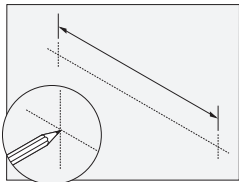

Figure 18

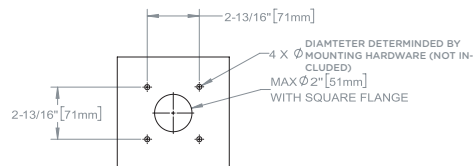

Figure 19

Section A:

1. Using the included dimensions (as shown in Figure 19), measure and mark centerlines for the mounting bracket on the subfloor as shown in Figure 18 (Max. 1-1/2" thickness as shown in Figure 20).
2. Using the floor flange (1) as a template, drill one 2" hole for the piping and four holes for mounting screws or lag bolts (not included).
3. Align the flexible hose 1/2-14 NPSM with the corner holes of the floor flange as shown in Figure 22 and use appropriate lag bolts or screws, depending on the material of the floor as shown in Figure 23. (Lag bolts/screws not included).

Note: The floor flange can be flipped and used as shown if necessary. Pipes come out of core hole with hot and cold soldered to respective supply stops.

Section B:

4. Slide the decorative flange onto the tub filler body as shown in Figure 24.
5. Attach the flange to the body, using the four screws provided as shown in Figure 25.

Section C:

6. Connect the cold and hot water inlets as shown in Figure 26. Turn on water supply and check for leaks.

Section D:

7. Push the connected flexible hoses under the subfloor, then connect the tub filler body and the floor flange together using the screws provided as shown in Figure 27.

Note: Do not tighten screws entirely.

8. Before tightening the screws, rotate the tub filler body to the preferred position for the spout as shown in Figure 28.
9. Slide the decorative flange over the floor flange until it is flush with the floor as shown in Figure 28.

Section E If Applicable:

10. If spout is packaged separately, attach the spout to tub filler body. Align the spout with pin in the tub filler body and tighten the set screw as shown in Figure 29.

Section F:

11. Connect the cold and hot water inlets as shown in Figure 30. Turn on water supply and check for leaks.

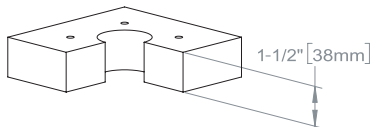

Figure 20

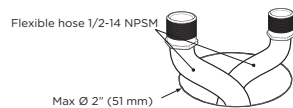

Figure 21

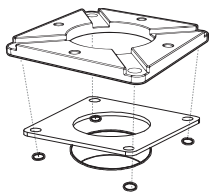

Figure 22

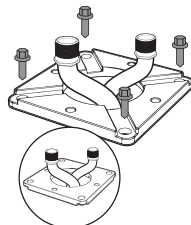

Figure 23

Section A

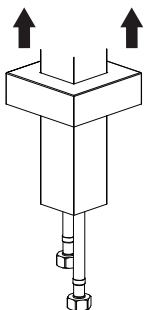

Figure 24

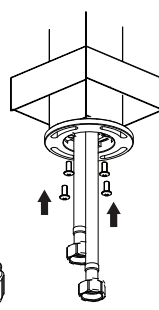

Figure 25

Section B

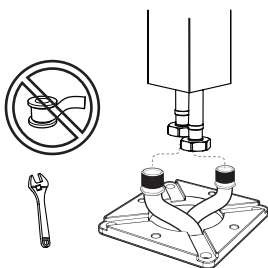

Figure 26
Section C

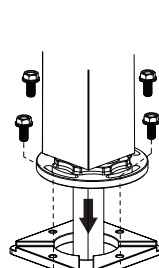

Figure 27

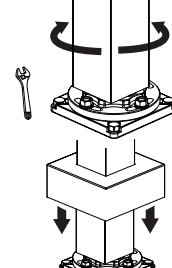

Figure 28

Section D

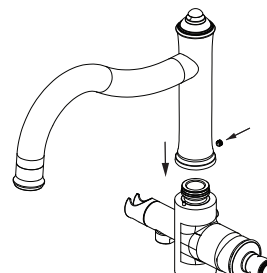

Figure 29
Section E

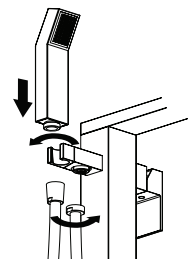

Figure 30
Section F