





Location:



Origins<sup>®</sup>



SLC-9610, SLC-9612  
Two Handle Centerset Lavatory Faucet  
**Specification Submittal**

<p><b>Feature Highlights</b></p> <ul style="list-style-type: none"> <li>• 4" mount</li> <li>• Quarter turn ceramic cartridges</li> <li>• 50/50 drain assembly (SLC-9612 only)</li> <li>• Standard 1.0 gpm (3.8 L/min) flow rate</li> <li>• Components shall be metal and nonmetallic construction, plated in standard polished chrome finish</li> </ul>	<p><b>Options/Modifications</b></p> <ul style="list-style-type: none"> <li><input type="checkbox"/> <b>-0.5</b>  0.5 gpm (1.9 L/min) flow restrictor</li> <li><input type="checkbox"/> <b>-G</b> Grid drain (SLC-9610)</li> <li><input type="checkbox"/> <b>-MP</b> Metal pop-up drain (SLC-9612)</li> <li><input type="checkbox"/> <b>-STN</b> Satin Nickel finish</li> </ul>
<p><b>Model Numbers</b></p> <ul style="list-style-type: none"> <li><input type="checkbox"/> <b>SLC-9610-1.0</b> Two handle centerset lavatory faucet, drain and lift rod hole not included</li> <li><input type="checkbox"/> <b>SLC-9612-1.0</b> Two handle centerset lavatory faucet</li> </ul>	<p><b>Note:</b> Append appropriate -suffix to model number.</p>
<p><b>Compliance</b></p> <p>ASME A112.18.1/CSA B125.1 NSF/ANSI/CAN 61: Q&lt;1, NSF/ANSI 372 WaterSense 1.0 gpm (3.8 L/min)</p>  	<p><b>Warranty</b></p> <p><b>Limited Lifetime</b> - to the original end purchaser in consumer/residential installations. <b>10 Years</b> - for commercial/industrial installations. Refer to <a href="http://www.symmons.com/warranty">www.symmons.com/warranty</a> for complete warranty information.</p> 

**Architectural/ Engineering Specification**

Symmons Origins Two Handle Centerset Lavatory Faucet \_\_\_\_\_ with 4" mount, quarter turn ceramic cartridge, 50/50 drain assembly (SLC-9612 only), Standard 1.0 gpm (3.8 L/min) flow rate, Components shall be metal and nonmetallic construction, plated in standard polished chrome finish. 10 Year Commercial Warranty. ASME A112.18.1/CSA B125.1, NSF/ANSI/CAN 61: Q<1, NSF/ANSI 372, WaterSense 1.0 gpm (3.8 L/min) complaint. Available options include: "-0.5 - 0.5 gpm (1.9 L/min) flow restrictor", "-G - grid drain (SLC-9610)", "-MP - metal pop-up drain (SLC-9612)", "-STN - satin Nickel finish".

## Dimensions

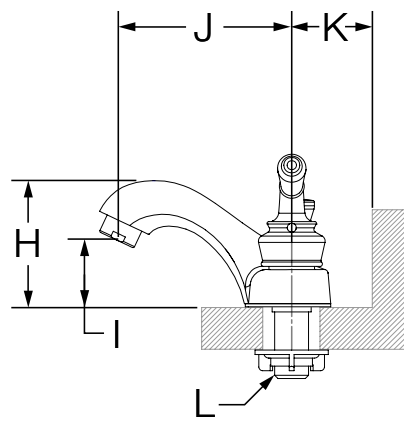
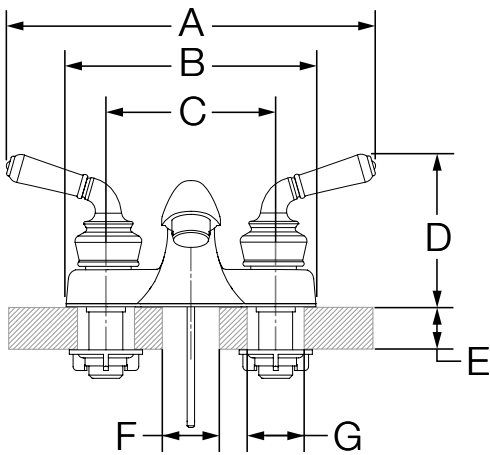

### Measurements

A	8 7/8", 225 mm
B	6", 152 mm
C	4", 102 mm
D	3-3/4", 95 mm
E	Deck Thickness Ref. Max. 1-1/4", 32 mm
F	Hole Size Min. Ø 1", 25 mm Max. Ø 1-1/8", 29 mm
G	(2x) Hole Size Min. Ø 1-1/8", 29 mm Max. Ø 1-1/4", 32 mm
H	3-1/8", 79 mm
I	1-5/8", 41 mm
J	4-1/4", 108 mm
K	1-3/4", 44 mm
L	1/2-14 NPSM

**Note:** Dimensions subject to change without notice.

Emplacement:



Origins®



SLC-9610, SLC-9612

Robinet de salle de bain monopièce à deux poignées  
**Manuel d'Opération et de Maintenance**

**Spécification**

- Configuration de fixation de 4 po
- Cartouches en céramique
- Ensemble pour drain 50/50 (SLC-9612 seulement)
- Débit standard de 1,0 gpm (3,8 l / min)
- Composants faits de métalliques et de matériaux non métalliques au fini chrome poli standard.

**Numéro de modèle**

- SLC-9610-1.0**  
Robinet de salle de bain monopièce à deux poignées aucune tige de levage
- SLC-9612-1.0**  
Robinet de salle de bain monopièce à deux poignées

**Conforme**

ASME A112.18.1/CSA B125.1  
NSF/ANSI/CAN 61: Q<1, NSF/ANSI 372  
WaterSense 1.0 gpm (3.8 L/min)



**Modifications**

- 0.5** *Aérateur de 0.5 gpm (1,9 L/min)*
- G** *Drain de la grille (SLC-9610)*
- MP** *Drain de robinet en métal (SLC-9612)*
- STN** *Fini nickel satiné*

**Remarque:** Juxtaposer le suffixe approprié au numéro demodèle.

**Garantie**

**Garantie limitée** - à l'acheteur original dans les installations du consommateur/résidentiel.  
**10 Ans** - pour les installations commerciales/industriel. Se reporter au [www.symmons.com/warranty](http://www.symmons.com/warranty) pour l'information complète concernant la garantie.



**Dimensions**

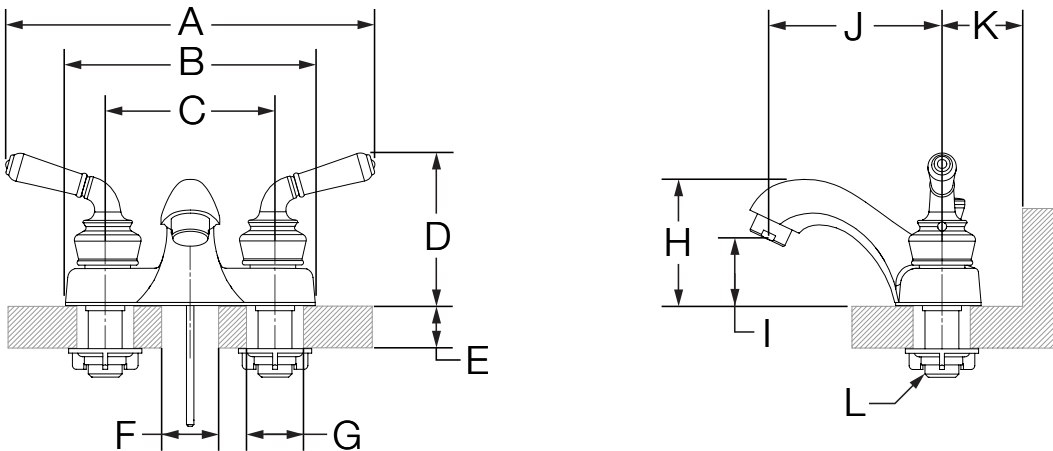

Mesures	
A	8 7/8 po, 225 mm
B	6 po, 152 mm
C	4 po, 102 mm
D	3-3/4 po, 95 mm
E	Épaisseur du comptoir Max. 1-1/4 po, 32 mm
F	Taille du trou Min. Ø 1 po, 25 mm Max. Ø 1-1/8 po, 29 mm
G	(2x) Taille du trou Min. Ø 1-1/8 po, 29 mm Max. Ø 1-1/4 po, 32 mm
H	3-1/8 po, 79 mm
I	1-5/8 po, 41 mm
J	4-1/4 po, 108 mm
K	1-3/4 po, 44 mm
L	1/2-14 NPSM

**Remarque:** Les dimensions sont sujettes à changer sans préavis.