







Location:



9602-PLR, 9602-PLR-TRM, 9602PLR, 9602PLRTRM, Tub/Shower Trim Specification Submittal

Feature Highlights	Options/Modifications
<ul style="list-style-type: none"> Origins Tub/Shower System or Trim Requires Temptrol® Pressure Balancing Tub/Shower Valve (included with 9602-PLR) Adjustable stop screw to limit handle turn (included with 9602-PLR) Metal lever handle 5-1/2" diverter tub spout 1 mode showerhead with easy to clean nozzles 2.0 gpm (7.6 L/min) flow restrictor Components shall be metal and nonmetallic construction, plated in standard Polished Chrome finish Available with TA-10 flow control spindle and T-12A cap assembly for Temptrol valve bodies installed with Test Cap (order p/n 9602PLRTRMTC) 	<ul style="list-style-type: none"> <input type="checkbox"/> -1.2  1.2 gpm (4.5 L/min) flow restrictor <input type="checkbox"/> -1.5  1.5 gpm (5.7 L/min) flow restrictor <input type="checkbox"/> -1.75  1.75 gpm (6.6 L/min) flow restrictor <input type="checkbox"/> L1 Less showerhead <input type="checkbox"/> L4 Less head, arm and flange <input type="checkbox"/> L7 Less handle <input type="checkbox"/> TC Test Cap Trim <input type="checkbox"/> -CHKS Integral check stops <input type="checkbox"/> -VP Vandal resistant escutcheon screws in place of standard screws <input type="checkbox"/> -STN Satin Nickel finish <input type="checkbox"/> -B Brass escutcheon (chrome only) <input type="checkbox"/> -X Integral service stops - allows water shut-off at valve for service
<h3>Model Numbers</h3>	
<ul style="list-style-type: none"> <input type="checkbox"/> 9602-PLR Tub/Shower Trim with Temptrol Pressure Balancing Shower Valve (modifiers include decimal points and hyphens) <input type="checkbox"/> 9602PLR Tub/Shower Trim with Temptrol Pressure Balancing Shower Valve (use when ordering L1-L7 modifications, do not use hyphens or decimal points) <input type="checkbox"/> 9602-PLR-TRM Tub/Shower Trim, Temptrol Pressure Balancing Shower Valve or-dered separately (modifiers include decimal points and hyphens) <input type="checkbox"/> 9602PLRTRM Tub/Shower Trim (use when ordering L1-L7 and TC modifications, do not use hyphens or decimal points) 	<h3>Warranty</h3> <p>Limited Lifetime - for residential installations. 10 Years - for commercial/industrial installations. Refer to www.symmons.com/warranty for complete warranty information.</p> 
<p>Note: -To create trim sku, follow the format: Base SKU -> PLR -> Finish -> Modifier (L1-L7) -> Flow Rate (if lower than standard) -> TRM -> TC (if applicable) -To create valve & trim sku, follow the format: Base SKU -> X or CHKS -> PLR -> Finish -> Modifier (L1-L7) -> Flow Rate (if lower than standard) -For B and REV modifications, contact customer service for your sku</p>	<h3>Compliance</h3> <ul style="list-style-type: none"> ASME A112.18.1/CSA B125.1 WaterSense 1.5 gpm (5.7 L/min), 2.0 gpm (7.6 L/min) Buy American Act (9602-PLR only)  

Architectural/Engineering Specification

Symmons Museo _____ With Origins Tub/Shower System or Trim, Requires Temptrol® Pressure Balancing Tub/Shower Valve (included with 9602-PLR), Adjustable stop screw to limit handle turn (included with 9602-PLR), Metal lever handle, 5-1/2" diverter tub spout, 1 mode showerhead with easy to clean nozzles, 2.0 gpm (7.6 L/min) flow restrictor, Components shall be metal and nonmetallic construction, plated in standard Polished Chrome finish, Available with TA-10 flow control spindle and T-12A cap assembly for Temptrol valve bodies installed with Test Cap (order p/n 9602PLRTRMTC). 10-Year Commercial Warranty. ASME A112.18.1/CSA B125.1, WaterSense 1.5 gpm (5.7 L/min), 2.0 gpm (7.6 L/min), complaint. Available options include: "1.2 - 1.2 gpm (4.5 L/min) flow restrictor", "1.5 - 1.5 gpm (5.7 L/min) flow restrictor", "1.75 - 1.75 gpm (6.6 L/min) flow restrictor", "L1 - Less showerhead", "L4 - Less head, arm and flange", "L6 - Less tub spout", "L7 - Less handle", "VP - Vandal resistant escutcheon screws in place of standard screws", "STN - Satin Nickel finish", "B - Brass escutcheon (chrome only)", "X - Integral service stops - allows water shut-off at valve for service", "CHKS - Integral Check Stop", and "TC - Test Cap Trim".

9602-PLR, 9602-PLR-TRM, 9602PLR, 9602PLRTRM

Dimensions

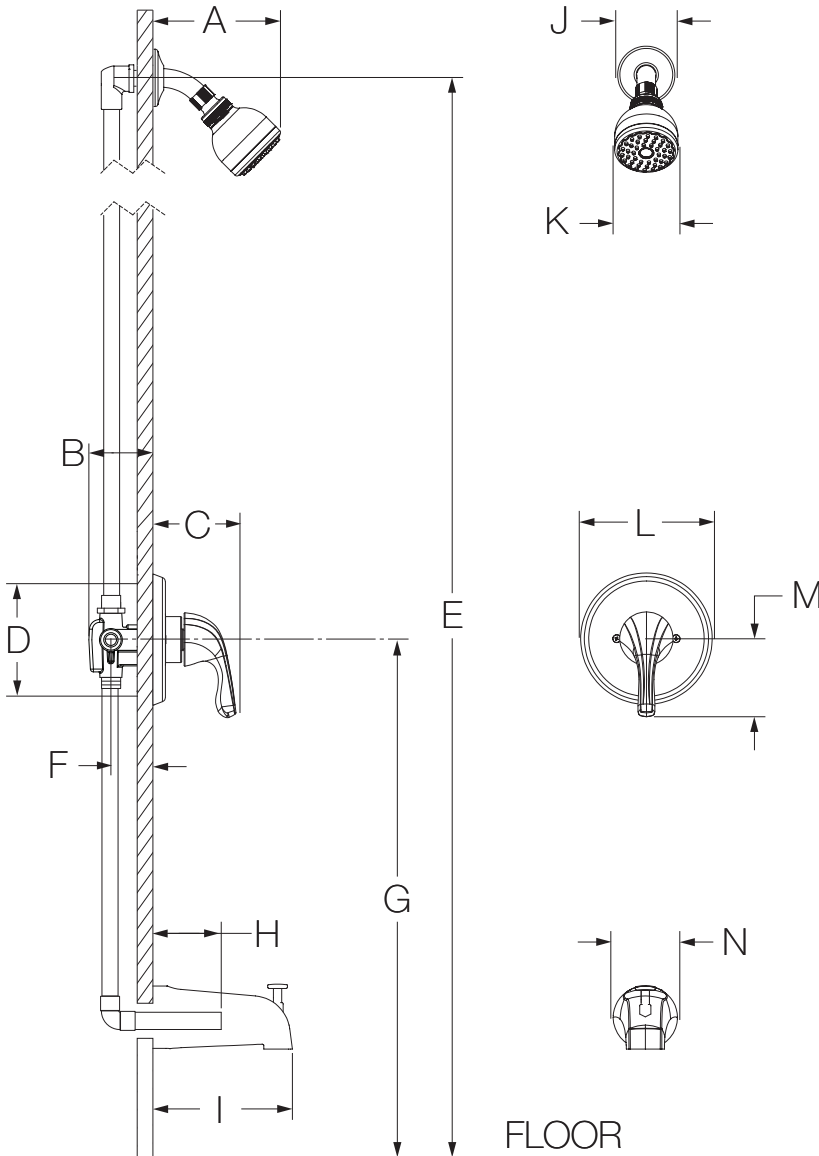

Measurements	
A	6-3/8", 162 mm
B	3-1/2", 89 mm
C	3-5/8", 92 mm
D	Shower Valve Hole Size Min. Ø 3", 76 mm Max. Ø 4", 102 mm
E	Ref. 77", 1956 mm
F	Rough-in 2-3/8" ± 1/2", 60 mm ± 13 mm
G	Ref. 32", 813 mm
H	1/2" rigid copper tubing must protrude Min. 1-1/2" (38 mm) Max. 2-7/8" (73 mm) from finished wall
I	5-1/4", 133 mm
J	Ø 2-1/2", 64 mm
K	Ø 2-3/4", 70 mm
L	Ø 5-3/4", 146 mm
M	3-3/8", 86 mm
N	Ø 2-1/2", 64 mm

Notes:

- 1) Valve body and piping not included and shown as reference only.
- 2) Plaster shield (p/n T-176) for dry wall, plaster or other type walls 1/2" or greater.
- 3) All dimensions measured from nominal rough-in (see F as reference).
- 4) Dimensions subject to change without notice.