

# Location:



# SYMMONS® Winslet®



S-5101-TRM, S5101TRMTC

Shower Trim

**Specification Submittal**



## Feature Highlights

- Winslet Shower Trim
- Requires Temptrol® Pressure Balancing Shower Valve
- Integral volume control
- Metal lever handle
- 1 mode showerhead
- 2.0 gpm (7.6 L/min) flow restrictor
- Tub spout not included
- Components shall be metal and nonmetallic construction, plated in standard Polished Chrome finish
- Available with TA-10 flow control spindle and T-12A cap assembly for Temptrol valve bodies installed with Test Cap (order p/n S5101TRMTC)

## Options/Modifications

- ☐ **-1.5**  1.5 gpm (5.7 L/min) flow restrictor
- ☐ **-L1** Less showerhead
- ☐ **-STN** Satin Nickel finish

**Note:** Append appropriate -suffix to model number.

## Model Numbers

- ☐ **S-5101-TRM**  
Shower Trim with integral volume control, Temptrol Pressure Balancing Shower Valve ordered separately
- ☐ **S5101TRMTC**  
Shower Trim with integral volume control, TA-10 flow control spindle and T-12A cap assembly, must order Temptrol valve with Test Cap

## Warranty

**Limited Lifetime** - to the original end purchaser in consumer/residential installations.

**10 Years** - for commercial/industrial installations. Refer to [www.symmons.com/warranty](http://www.symmons.com/warranty) for complete warranty information.



## Compliance

- ASME A112.18.1/CSA B125.1



## Architectural/ Engineering Specification

Symmons \_\_\_\_\_ With Winslet Shower Trim, Requires Temptrol® Pressure Balancing Shower Valve, Integral volume control, Metal lever handle, 1 mode showerhead, 2.0 gpm (7.6 L/min) flow restrictor, Tub spout not included, Components shall be metal and nonmetallic construction, plated in standard Polished Chrome finish, Available with TA-10 flow control spindle and T-12A cap assembly for Temptrol valve bodies installed with Test Cap (order p/n S5101TRMTC), 10 Year commercial Warranty. ASME A112.18.1/CSA B125.1 complaint. Available options include: "1.5 - 1.5 gpm (5.7 L/min) flow restrictor", "L1 - Less showerhead", "STN - Satin Nickel finish.

S-5101-TRM, S5101TRMTC

## Dimensions

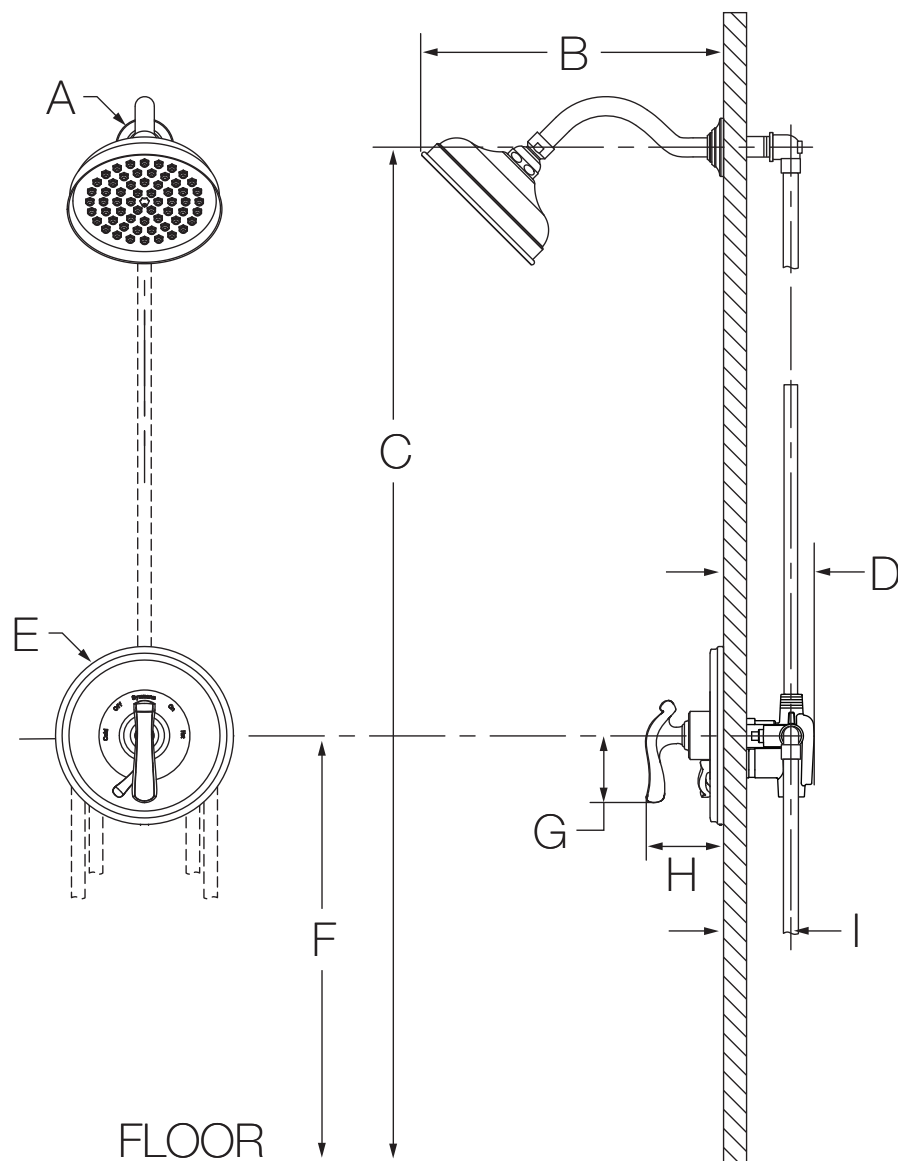

Measurements	
<b>A</b>	Ø 2-1/2" 64 mm
<b>B</b>	12" 305 mm
<b>C</b>	Ref. 77", 1956 mm
<b>D</b>	3-1/2", 89 mm
<b>E</b>	Ø 7-1/2", 191 mm
<b>F</b>	Ref. 42", 1067 mm
<b>G</b>	2-7/8", 73 mm
<b>H</b>	3-1/8", 79 mm
<b>I</b>	Rough-in 2-3/8" ± 1/2", 60 mm ± 13 mm

### Notes:

- 1) Valve body and piping not included and shown as reference only.
- 2) Plaster shield (p/n T-176) for dry wall, plaster or other type walls 1/2" or greater.
- 3) All dimensions measured from nominal rough-in (see I as reference).
- 4) Dimensions subject to change without notice.