

Location:



SYMMONS®

Origins®



SLC9610, SLC9612

Two Handle Centerset Lavatory Faucet Specification Submittal

Feature Highlights

- 4" mount
- Quarter turn ceramic cartridges
- 50/50 drain assembly (SLC9612 only)
- Standard 1.0 gpm (3.8 L/min) flow rate
- Components shall be metal and nonmetallic construction, plated in standard polished chrome finish

Model Numbers

- ☐ **SLC9610**
Two handle centerset lavatory faucet, drain and lift rod hole not included
- ☐ **SLC9612**
Two handle centerset lavatory faucet

Compliance

ASME A112.18.1/CSA B125.1
NSF/ANSI/CAN 61: Q<1, NSF/ANSI 372
WaterSense 1.0 gpm (3.8 L/min)



Options/Modifications

- ☐ **05**  0.5 gpm (1.9 L/min) flow restrictor
- ☐ **G** Grid drain (SLC9610)
- ☐ **MP** Metal pop-up drain (SLC9612)
- ☐ **STN** Satin Nickel finish

Note: Append appropriate suffix to model number.

Warranty

Limited Lifetime - to the original end purchaser in consumer/residential installations.

10 Years - for commercial/industrial installations. Refer to www.symmons.com/warranty for complete warranty information.



Architectural/ Engineering Specification

Symmons Origins Two Handle Centerset Lavatory Faucet _____ with 4" mount, quarter turn ceramic cartridge, 50/50 drain assembly (SLC9612 only), Standard 1.0 gpm (3.8 L/min) flow rate, Components shall be metal and nonmetallic construction, plated in standard polished chrome finish. 10 Year Commercial Warranty. ASME A112.18.1/CSA B125.1, NSF/ANSI/CAN 61: Q<1, NSF/ANSI 372, WaterSense 1.0 gpm (3.8 L/min) complaint. Available options include: "05 - 0.5 gpm (1.9 L/min) flow restrictor", "G - grid drain (SLC9610)", "MP - metal pop-up drain (SLC9612)", "STN - satin Nickel finish".

Dimensions

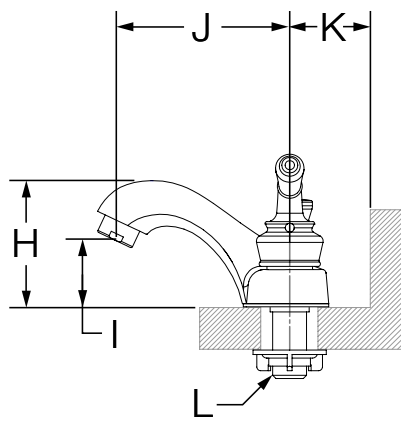
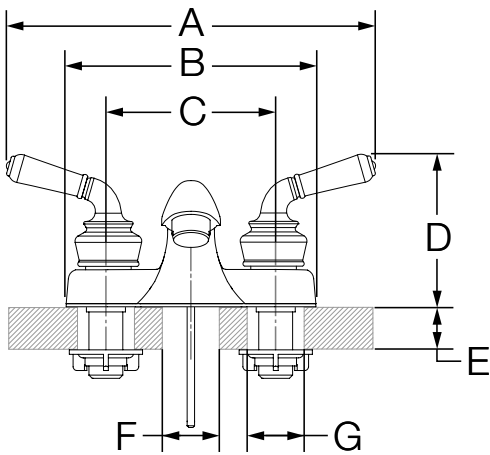

Measurements	
A	8 7/8", 225 mm
B	6", 152 mm
C	4", 102 mm
D	3-3/4", 95 mm
E	Deck Thickness Ref. Max. 1-1/4", 32 mm
F	Hole Size Min. Ø 1", 25 mm Max. Ø 1-1/8", 29 mm
G	(2x) Hole Size Min. Ø 1-1/8", 29 mm Max. Ø 1-1/4", 32 mm
H	3-1/8", 79 mm
I	1-5/8", 41 mm
J	4-1/4", 108 mm
K	1-3/4", 44 mm
L	1/2-14 NPSM

Note: Dimensions subject to change without notice.

Emplacement:



SYMMONS®

Origins®



SLC9610, SLC9612

Robinet de salle de bain monopièce à deux poignées

Manuel d'Opération et de Maintenance

Spécification

- Configuration de fixation de 4 po
- Cartouches en céramique
- Ensemble pour drain 50/50 (SLC9612 seulement)
- Débit standard de 1,0 gpm (3,8 l / min)
- Composants faits de métalliques et de matériaux non métalliques au fini chrome poli standard.

Numéro de modèle

- ☐ **SLC9610**
Robinet de salle de bain monopièce à deux poignées
aucune tige de levage
- ☐ **SLC9612**
Robinet de salle de bain monopièce à deux poignées

Conforme

ASME A112.18.1/CSA B125.1
NSF/ANSI/CAN 61: Q<1, NSF/ANSI 372
WaterSense 1.0 gpm (3.8 L/min)



Modifications

- ☐ **05** *Aérateur de 0.5 gpm (1,9 L/min)*
- ☐ **G** *Drain de la grille (SLC9610)*
- ☐ **MP** *Drain de robinet en métal (SLC9612)*
- ☐ **STN** *Fini nickel satiné*

Remarque: Juxtaposer le suffixe approprié au numéro demodèle.

Garantie

Garantie limitée - à l'acheteur original dans les installations du consommateur/résidentiel.

10 Ans - pour les installations commerciales/industriel. Se reporter au www.symmons.com/warranty pour l'information complète concernant la garantie.



Dimensions

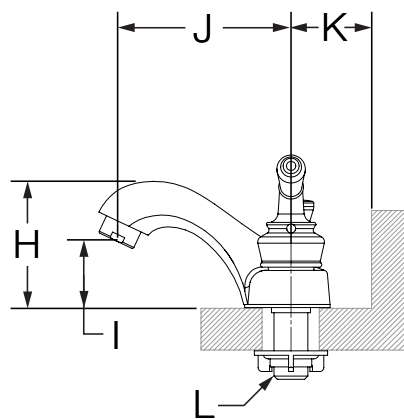
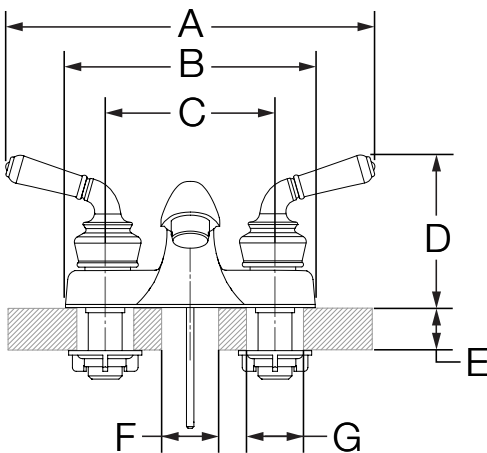

Mesures

A	8 7/8 po, 225 mm
B	6 po, 152 mm
C	4 po, 102 mm
D	3-3/4 po, 95 mm
E	Épaisseur du comptoir Max. 1-1/4 po, 32 mm
F	Taille du trou Min. Ø 1 po, 25 mm Max. Ø 1-1/8 po, 29 mm
G	(2x) Taille du trou Min. Ø 1-1/8 po, 29 mm Max. Ø 1-1/4 po, 32 mm
H	3-1/8 po, 79 mm
I	1-5/8 po, 41 mm
J	4-1/4 po, 108 mm
K	1-3/4 po, 44 mm
L	1/2-14 NPSM

Remarque: Les dimensions sont sujettes à changer sans préavis.