



SYMMONS® Duro®

Location:

SLS3622CA

Single Handle Lavatory Faucet

Specification Submittal

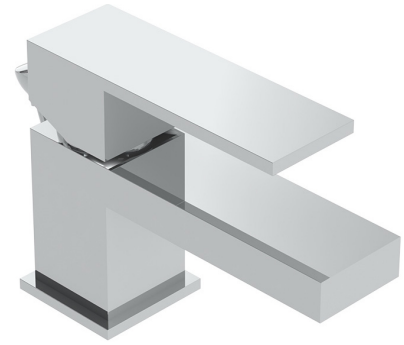

Model Numbers

- ☐ **SLS3622CA** Single Handle Lavatory Faucet with lift rod and metal drain assembly

Options/ Modifications

- ☐ **BBZ** **Brushed Bronze finish**
- ☐ **MB** **Matte Black finish**
- ☐ **STN** **Satin Nickel finish**

Note: Append appropriate suffix to model number.

Compliance

- ASME A112.18.1/CSA B125.1
- NSF/ANSI/CAN 61: Q<1, NSF/ANSI 372
- WaterSense 1.0 gpm (3.8 L/min) only



Feature Highlights

- Single hole mount configuration
- Single lever cartridge with ceramic control components
- 25 inch braided hose water supply connections
- 4-1/2" height
- Standard 1.0 gpm (3.8 L/min) flow rate
- Faucet shall be metal construction, plated in standard polished chrome finish

Warranty

Limited Lifetime - to the original end purchaser in consumer/residential installations.

10 Years - for commercial/industrial installations. Refer to www.symmons.com/warranty for complete warranty information.

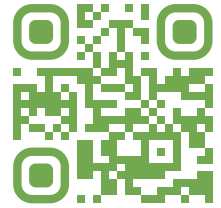

Architectural/ Engineering Specification

Symmons Duro Single Handle Lavatory Faucet _____ With Single hole mount configuration, Single lever cartridge with ceramic control components, 25 inch braided hose water supply connections, 4-1/2" height, Standard 1.0 gpm (3.8 L/min) flow rate, Faucet shall be metal construction, plated in standard polished chrome finish. 10 Year commercial Warranty. ASME A112.18.1/CSA B125.1, NSF/ANSI/CAN 61: Q<1, NSF/ANSI 372, WaterSense 1.0 gpm (3.8 L/min) only complaint. Available options include: "BBZ - Brushed Bronze finish", "MB - Matte Black finish", "STN - Satin Nickel finish".

SLS3622CA

Dimensions

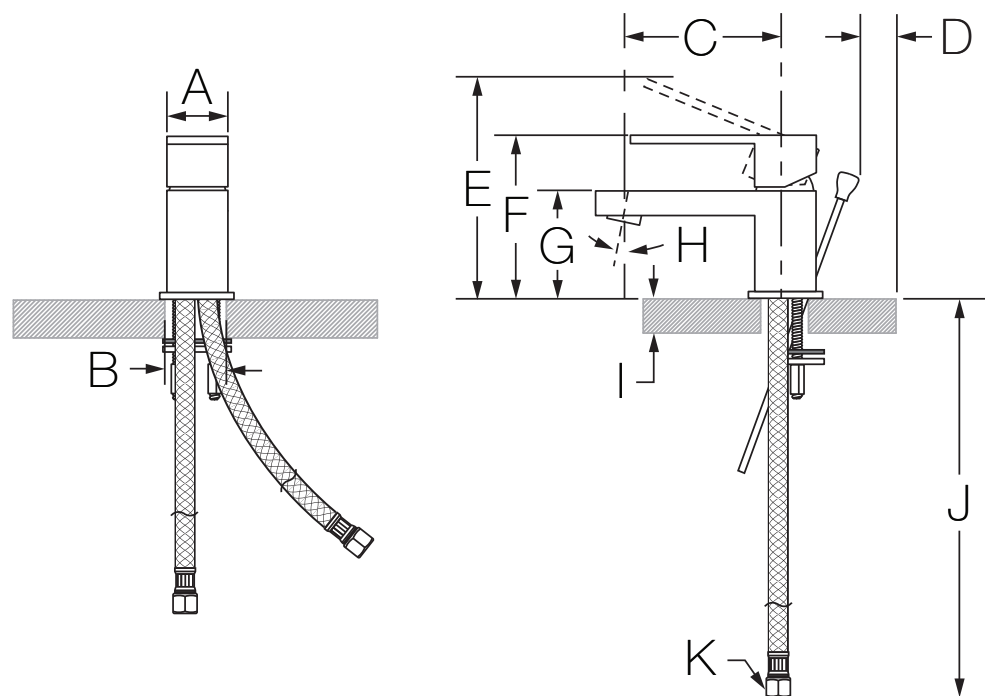

Measurements	
A	1-11/16", 43 mm
B	Hole Size: Min. Ø 1-1/4", 32 mm Max. Ø 1-1/2", 38 mm
C	4-5/8", 118 mm
D	Min. 1/2", 13 mm
E	6-9/16", 167 mm
F	4-1/2", 114 mm
G	3-1/2", 89 mm
H	12°
I	Deck Thickness Ref. Min. 7/8", 22 mm Max. 2-1/2", 64 mm
J	25", 635 mm
K	3/8" compression fitting

Note: Dimensions subject to change without notice.